

## ON-GOING MAINTENANCE continued

Step 4. Check inside valve body and remove any debris if required.  
Re-rinse the cartridge under running water and replace the cartridge in valve body, use silicone grease as necessary and securely tighten turning clockwise

### Step 4

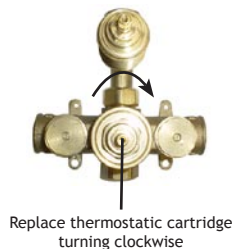

Step 5 Turn on the hot and cold water supply .

### Step 5

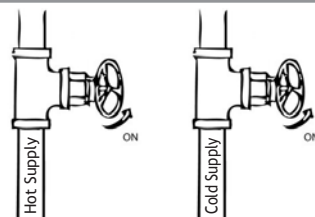

Step 6 Replace thermostatic cartridge sleeve and trim ring

Re-set the temperature using the "Setting The Temperature" guide.

### Step 6

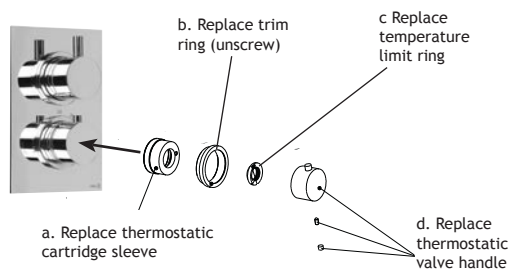

## GENERAL CLEANING

1. We recommend that Cifial products are cleaned using a **soft damp cloth**, we strongly advise against using any cleaning products, either powders or liquids, as they may contain harmful chemicals which may damage the product.
2. Shower heads need to be regularly "rubbed" to prevent the build up of limescale on the outlet nozzles.

CIFIAL

IMPORTANT  
care and maintenance



## Concealed Thermostatic Shower Valve

Please leave this booklet  
with the customer  
for future use

## IMPORTANT - PRIOR TO USE

### SETTING THE TEMPERATURE

#### Step 1

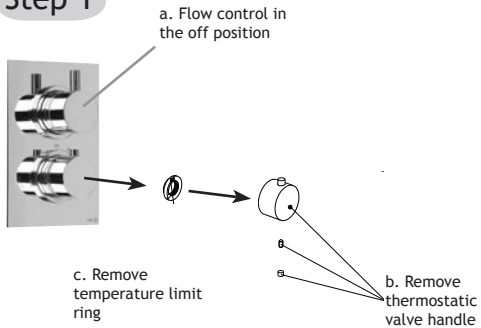

- Ensure the flow control is in the OFF position.
- Remove the thermostatic valve handle.
- Remove the temperature limit ring

#### Step 3

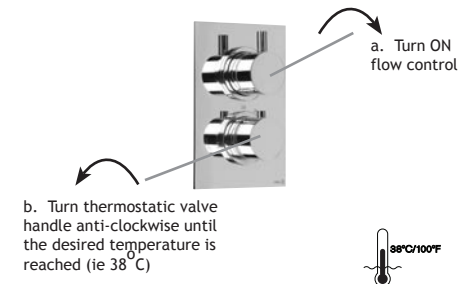

- Turn ON flow control
- Turn the thermostatic valve handle anti-clockwise until the desired temperature is reached, is 38°C. Use a thermometer to check if the temperature is correct.

#### Step 5

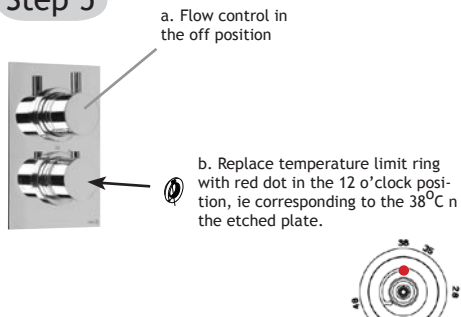

- Ensure the flow control is still in the OFF position
- Replace the temperature limit ring with the red dot in the 12 o'clock position, ie corresponding with 38°C on the etched plate

#### Step 2

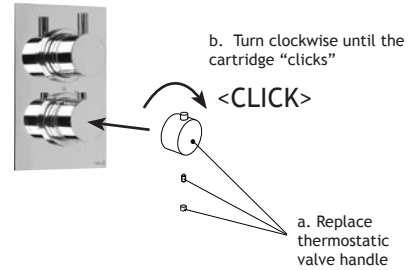

- Replace the thermostatic valve handle
- Turn thermostatic valve handle clockwise until the cartridge "clicks". The valve is now fully set at COLD.

#### Step 4

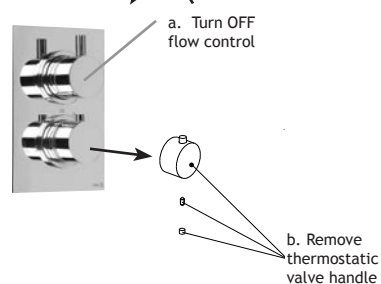

- Turn OFF flow control.
- Remove the thermostatic valve handle.

#### Step 6

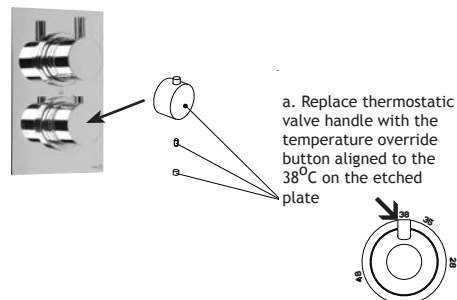

- Replace thermostatic valve handle with the temperature override button aligned to the 38°C on the etched plate.  
YOUR VALVE IS NOW READY FOR USE.

### ON-GOING MAINTENANCE

To prevent the build up of limescale and water impurities, especially in hard water areas, it is recommended to follow these procedures:

- On a monthly basis the thermostatic control handle should be rotated between the maximum and minimum limits by pressing the override button and with the water running.
- Should the thermostatic cartridge not function properly the most likely cause is the build up of limescale/water impurities.

To clean the cartridge:  
part number 5711607

Step 1. Shut off both the hot & cold water supply to the thermostatic valve

#### Step 1

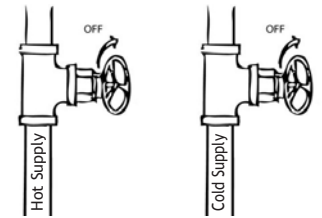

Step 2. Remove the thermostatic valve handle, limit ring, trim ring and thermostatic cartridge sleeve

#### Step 2

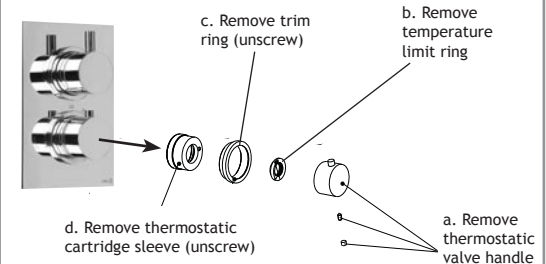

Step 3. Using a 24mm spanner, unscrew the thermostatic cartridge anti-clockwise and remove it  
To clean the cartridge first rinse under running water then soak overnight in vinegar

#### Step 3

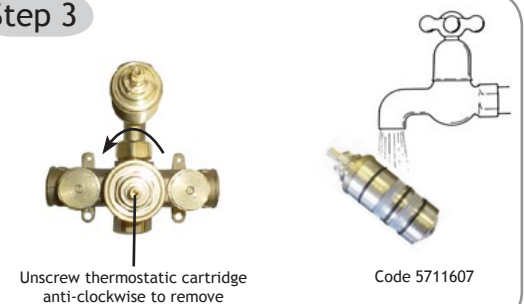

cont .....